



## Radon Test Results Report

Client Joe Sample

Test address 123456 Any Road

Average radon level during test was:

**\*\* ( 10.8 ) \*\***

City Anytown State Ohio Zip 12345  
Phone 555-456-7890 County Franklin

Weather Conditions Warm 70's Sunny  
Soil Conditions Damp/dry Wind 0-5mph

Test unit Ser. # 83591061 Test manufacturer, make and model: Sun Nuclear Corp. Model 1028

Start time: 14:44pm Date: 05/22/2014 Placed by: Ed Winkleman c/o License# RT809

Stop time: 14:44pm Date: 05/24/2014 Picked up: Ed Winkleman c/o License# RT809

Test duration was at least 48 contiguous hours of usable data? **Yes/No**

Mitigation system present during placement and retrieval? **Yes/No** Was it operating? **Yes/No**

Severe weather conditions during test? **Yes/No**: If yes,  
explain: \_\_\_\_\_

Tampering/Interference observed? **Yes/No**: If yes,  
explain: \_\_\_\_\_

Any permanent vents observed that allow outdoor air into the building, crawl vents or combustion air supply to  
combustive appliances? **Yes/No**: If yes,  
explain: \_\_\_\_\_

### PURPOSE OF THIS INSPECTION REPORT

To provide a professional opinion of a structure's radon levels at the time of the test period, limited to the conditions identified in this report.

### BUREAU OF RADIATION PROTECTION, OHIO DEPARTMENT OF HEALTH RECOMMENDED ACTIONS

For time sensitive (real estate) tests: When the test results are 4.0 pCi/l or greater, radon mitigation is recommended. If the radon test result is less than 4.0pCi/l the recommendation is to retest in two years or if any renovations or additions are made to the building.

### EPA EXPLANATION OF TEST RESULTS

Radon is the second leading cause of lung cancer, after smoking. The U.S. Environmental Protection Agency (EPA) and the Surgeon General strongly recommend taking further action when the home's radon test results are 4.0 pCi/l (picocuries per liter of air) or greater. Radon levels less than 4.0 pCi/l still pose some risk and in many cases may be reduced. The national average indoor radon level is about 1.3 pCi/l while outdoor radon levels average 0.4 pCi/l. The higher a home's radon level, the greater the health risk to you and your family. Smokers and former smokers are at especially high risk. EPA recommends that you use an EPA or State approved contractor trained to fix radon problems. You can call your state radon office to obtain information, including a list of EPA or State-approved radon contractors who can fix or can help you develop a plan for fixing the radon problem.

### LIMITATIONS OF LIABILITY

**Winkleman Home Inspections** cannot guarantee the necessary conditions were maintained during the test period. There can be uncertainty with any radon measurement due to statistical variations and other factors such as changes in the weather and operation of the dwelling. While we and our agents make every effort to maintain the highest possible quality control and include checks and verification steps in our procedures, we make NO WARRANTY OF ANY KIND, EXPRESSED OR IMPLIED, for the consequences of erroneous test results.

**Winkleman Home Inspections** nor its employees or agents shall not be liable under any claim, charge or demand, whether in contract, tort, or otherwise, for any and all loss, cost, charge, claim, demand, fee, or expense of any nature or kind arising out of, connected with, resulting from, or sustained as a result of any radon test.

**RADON TEST DATA**

Attached to this report is a copy of the actual test data taken from the testing device. This test was done with a *Sun Nuclear 1028*, an EPA approved testing device. The test was performed in accordance with the current standards and guidelines accepted for radon testing.

*The monitor location(s) were:* On top of a tripod in the rear part of the basement.

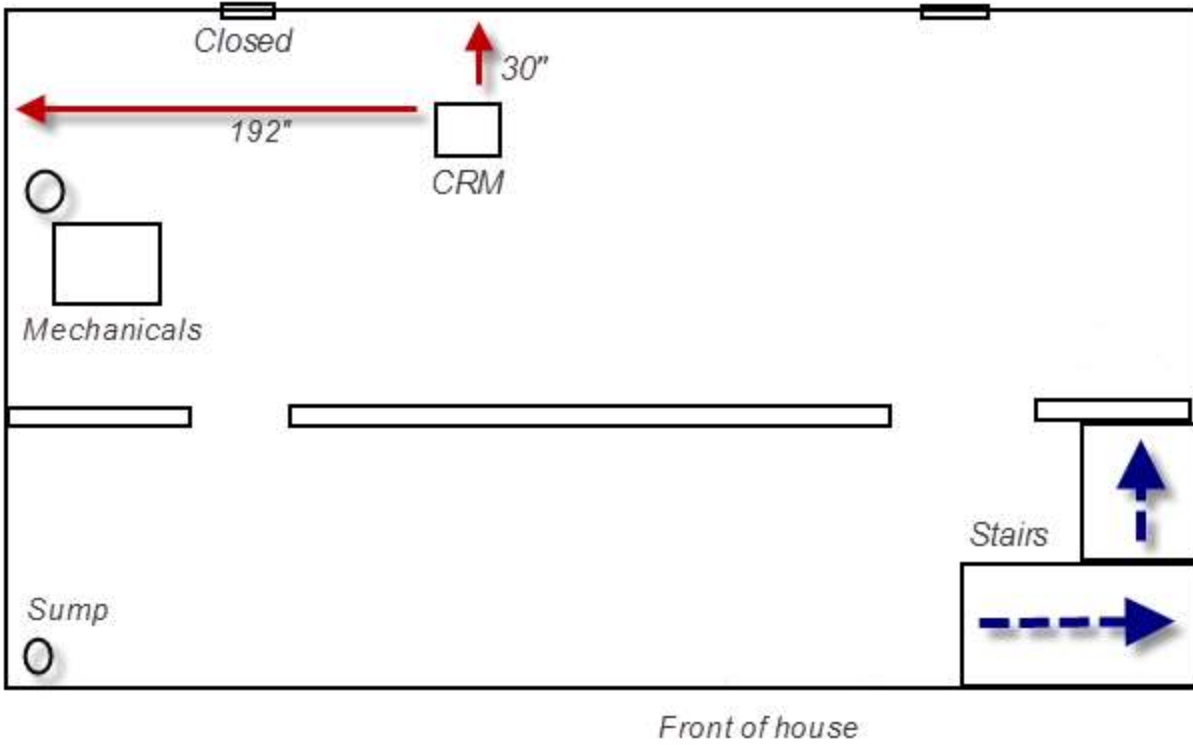

The following graph shows the pCi/l measured per hour.

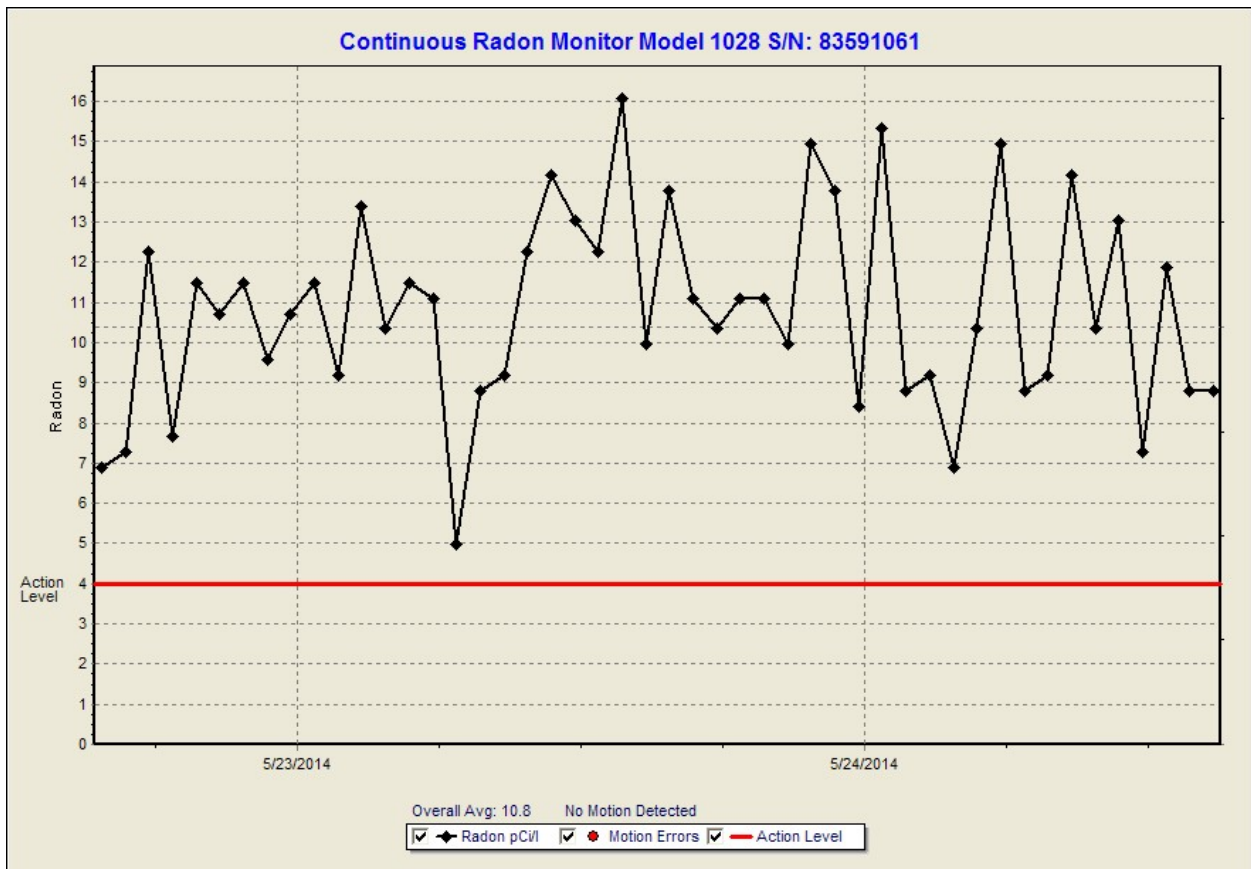

This Radon Test Report has been prepared in accordance with the requirements of Ohio Revised Code 3723 and Ohio Administrative Code 3701-69.

Licensee Name Sole Tester(Print): Edwin Winkleman ODH Lic# RT809

Signature: s/o Edwin Winkleman Date: 05/25/2014